

HYUNDAI MOBIS

Strategy for electrification parts business



xEV Market

Overall market expected to grow to 2,053 million units (M/S 19%)



M/S ('25) by research agency

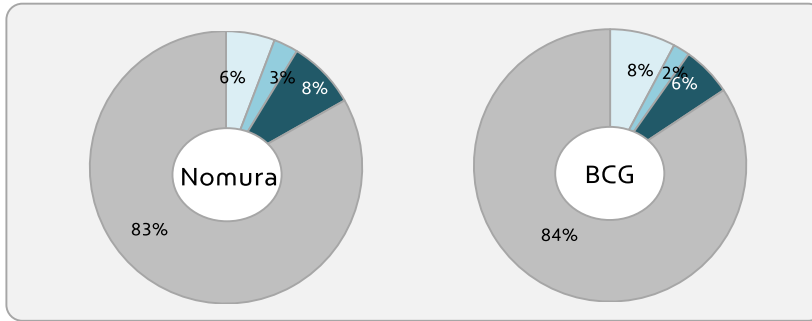

[unit : 10k]

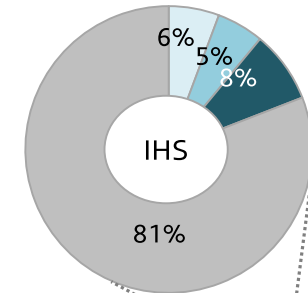

※ Excepting Mild HEV(48V)

EV: MS 8% of overall automotive market

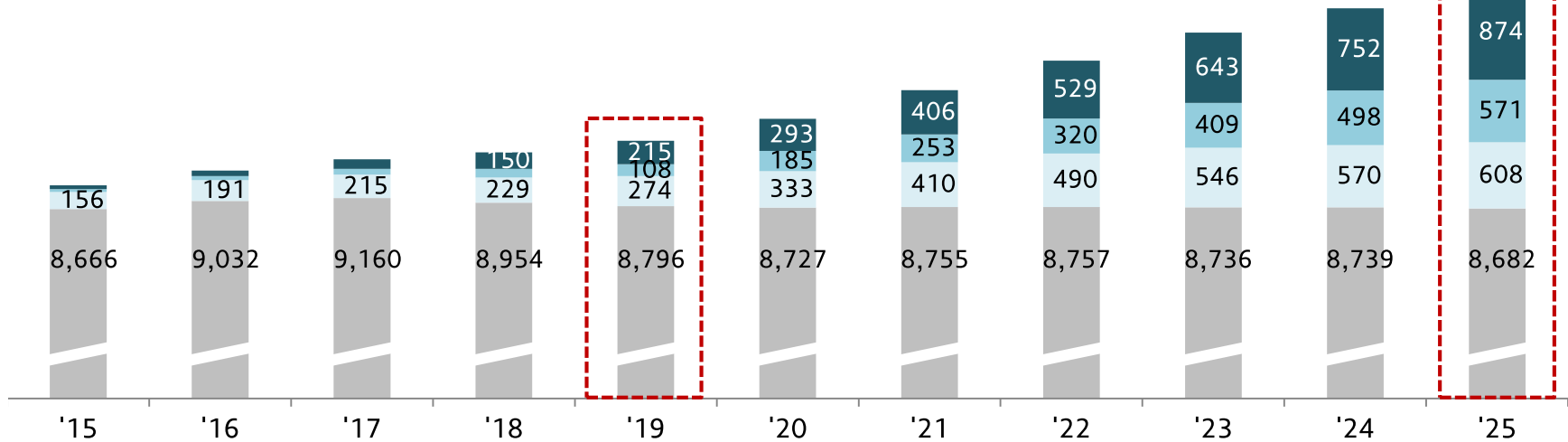

Source: IHS

Trend in EV Industry

Key players to accomplish the eco. of scale for EV by launching EV-only platform.

- Car maker
- Parts maker

● Volkswagen



3 types of EVs that apply the MEB* platform in 2020

※ MEB(Modular Electrification Toolkit)
: Module-type platform exclusively for futuristic electric vehicles developed by VW

● ZF



Investment plan of \$0.9B for 4 years to prepare for market change (ICE → xEV)

● GM



(BEV2 platform)

More than 20 new EVs that utilize the new EV platform BEV3 (2021)

● SK innovation



Investment plan of \$3.8B to build battery cell plant (2018~2022)

● Hyundai KIA



(Excerpt from 2019 CES presentation materials)

14 new EVs applying EV-only platform (E-GMP*, eK3) (in 2020)

※ E-GMP(Electric-Global Modular Platform)

● DENSO



EV Innovation Center('20)

Investment plan of \$1.6B for 3 years for EV parts (2018~2020)

Major Business Product

MOBIS developing key electrification Parts for EV and FCEV



Traction Motor

- Energy Transform (Electricity → Kinetic)
- EV Driving, Deceleration and Regen. at breaking



Battery System

- Electric Energy Storage and Supply



Inverter
(Power Conversion)

- Converting DC to AC
- Control Torque and Velocity of Motor



Fuel Cell System

- Chemical reaction both Hydrogen and Oxygen to supply electric energy

R&D Status

Increasing power density and efficiency / Securing cost competitiveness

Technology in Production



Motor

Increasing Torque Density
1) Increasing Magnetic Density
2) Decreasing Core Thickness

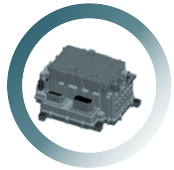

Controller (Inverter/OBC)

Improving Cooling Structure
- Single Side → Dual Side
Reducing No. of Power Device
- 6 → 4 units



Battery Sys. (Pack/BMS)

Changing Material for W.R.
- STEEL → AL
Cooling Type
- Air → Liquid → Refrigerant



Fuel Cell

Customizing Pt Catalytic Amount for Cost Reduction

Advanced Technology



In Wheel Motor

Developed Direct Driving In Wheel System for Next EV

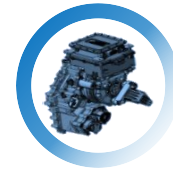

Driving Sys. (3 in 1)

Medialization of Motor, Inverter and Reduction Gear

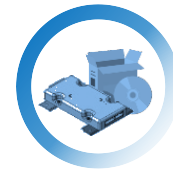

SW (BMS^{1]})

Advanced Logic to Monitor & Control Battery Status for Extending Driving Range
- SOH, SOC

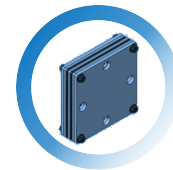

MEA^{2]}

Highly Active, Highly Durable Grade for Low Cost
Low Cost Structural Design

1] BMS : Battery Management System , 2] MEA : Membrane Electrode Assembly

Production Site and Sales Status

Consider the expansion of existing facilities, home & abroad
 Continuous growth in electrification sales

Production Site

| Korea

- ✓ Chungju: All Parts (Motor, Inverter, Battery Sys.)
- ✓ Ulsan: EV Battery System for **EV-only platform** (Under Cont.)



| Overseas

Promoting Battery Oriented Localization Related to Car Maker Plan to Reduce Logistic Costs

Sales

[Unit: Trillion Won]

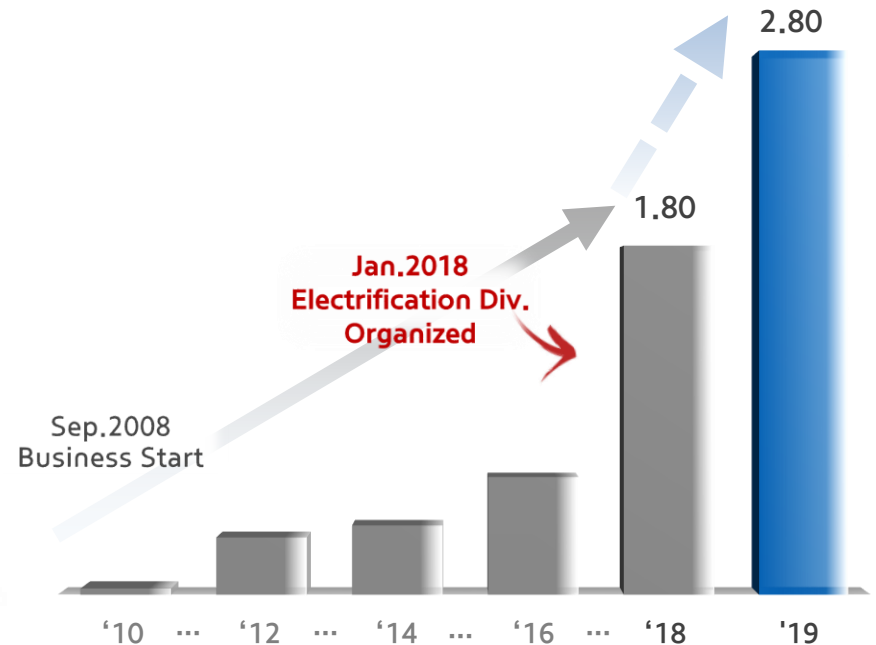

Business Road Map

Expanding business portfolio based on EV parts competitiveness

Captive Oriented



- ✓ Base of the Business Expansion
 - High Efficiency & Performance
 - Low Cost for competitiveness

Global Biz.

Global Major OEs

- ✓ Transform to Global Tier
 - Customer Market Driven

New Mobility



- ✓ Responding to Market Change
 - Ambition Driven

New Business of Fuel Cell



- ✓ Leading Hydrogen Economy Society
 - Competence Driven

이 종목의 더 많은 IR정보 [확인하기](#)

IR GO 주주와 기업을 연결하고 응원합니다.